

LOAD AND RESISTANCE FACTOR RATING (LRFR) SUMMARY FOR PRESTRESSED CONCRETE GIRDERS																							
LOAD TYPE	VEHICLE	WEIGHT (W) (TONS)	CONTROLLING LOAD RATING Ⓢ	MINIMUM RATING FACTORS (RF)	TONS = W x RF	STRENGTH I LIMIT STATE										SERVICE III LIMIT STATE						COMMENT NUMBER	
						LIVE-LOAD FACTORS (γ LL)	MOMENT				SHEAR				LIVE-LOAD FACTORS (γ LL)	MOMENT							
							DISTRIBUTION FACTORS (DF)	RATING FACTOR	SPAN	GIRDER LOCATION	DISTANCE FROM LEFT END OF SPAN (ft)	DISTRIBUTION FACTORS (DF)	RATING FACTOR	SPAN		GIRDER LOCATION	DISTANCE FROM LEFT END OF SPAN (ft)	DISTRIBUTION FACTORS (DF)	RATING FACTOR	SPAN	GIRDER LOCATION		DISTANCE FROM LEFT END OF SPAN (ft)
DESIGN LOAD	HL-93 (INVENTORY)	N/A	Ⓢ1	1.16	-	1.75	0.249	1.36	55'	EL	26.923	0.659	1.21	55'	EL	10.769	0.80	0.249	1.16	55'	EL	26.923	
	HL-93 (OPERATING)	N/A		1.56	-	1.35	0.249	1.76	55'	EL	26.923	0.659	1.56	55'	EL	10.769	N/A	--	--	--	--	--	
	HS-20 (INVENTORY)	36.000	Ⓢ2	1.42	51.265	1.75	0.249	1.70	55'	EL	26.923	0.659	1.42	55'	EL	10.769	0.80	0.249	1.46	55'	EL	26.923	
	HS-20 (OPERATING)	36.000		1.85	66.455	1.35	0.249	2.20	55'	EL	26.923	0.659	1.85	55'	EL	10.769	N/A	--	--	--	--	--	
LEGAL LOAD	SINGLE VEHICLE (SV)	SNSH		3.06	41.264	1.4	0.249	4.46	55'	EL	26.923	0.659	3.96	55'	EL	10.769	0.80	0.249	3.06	55'	EL	26.923	
		SNGARBS2		2.37	47.473	1.4	0.249	3.46	55'	EL	26.923	0.659	2.90	55'	EL	10.769	0.80	0.249	2.37	55'	EL	26.923	
		SNAGRIS2		2.29	50.392	1.4	0.249	3.34	55'	EL	26.923	0.659	2.72	55'	EL	10.769	0.80	0.249	2.29	55'	EL	26.923	
		SNCOTTS3		1.52	41.521	1.4	0.249	2.22	55'	EL	26.923	0.659	1.98	55'	EL	10.769	0.80	0.249	1.52	55'	EL	26.923	
		SNAGGRS4		1.31	45.740	1.4	0.249	1.91	55'	EL	26.923	0.659	1.71	55'	EL	10.769	0.80	0.249	1.31	55'	EL	26.923	
		SNS5A		1.28	45.439	1.4	0.249	1.86	55'	EL	26.923	0.659	1.76	55'	EL	10.769	0.80	0.249	1.28	55'	EL	26.923	
		SNS6A		1.19	47.481	1.4	0.249	1.73	55'	EL	26.923	0.659	1.63	55'	EL	10.769	0.80	0.249	1.19	55'	EL	26.923	
		SNS7B		1.13	47.562	1.4	0.249	1.65	55'	EL	26.923	0.659	1.64	55'	EL	10.769	0.80	0.249	1.13	55'	EL	26.923	
	TRUCK TRACTOR SEMI-TRAILER (TTST)	TNAGRIT3		1.45	47.984	1.4	0.249	2.12	55'	EL	26.923	0.659	1.92	55'	EL	10.769	0.80	0.249	1.45	55'	EL	26.923	
		TNT4A		1.46	48.451	1.4	0.249	2.14	55'	EL	26.923	0.659	1.85	55'	EL	10.769	0.80	0.249	1.46	55'	EL	26.923	
		TNT6A		1.21	50.478	1.4	0.249	1.77	55'	EL	26.923	0.659	1.81	55'	EL	10.769	0.80	0.249	1.21	55'	EL	26.923	
		TNT7A		1.23	51.576	1.4	0.249	1.79	55'	EL	26.923	0.659	1.67	55'	EL	10.769	0.80	0.249	1.23	55'	EL	26.923	
		TNT7B		1.28	53.827	1.4	0.249	1.87	55'	EL	26.923	0.659	1.58	55'	EL	10.769	0.80	0.249	1.28	55'	EL	26.923	
		TNAGRIT4		1.21	52.158	1.4	0.249	1.77	55'	EL	26.923	0.659	1.52	55'	EL	10.769	0.80	0.249	1.21	55'	EL	26.923	
		TNAGT5A		1.14	51.134	1.4	0.249	1.66	55'	EL	26.923	0.659	1.55	55'	EL	10.769	0.80	0.249	1.14	55'	EL	26.923	
		TNAGT5B	Ⓢ3	1.12	50.224	1.4	0.249	1.63	55'	EL	26.923	0.659	1.44	55'	EL	10.769	0.80	0.249	1.12	55'	EL	26.923	
EMERGENCY VEHICLE (EV)	EV2		1.64	47.205	1.3	0.249	2.62	55'	EL	29.620	0.659	1.64	55'	EL	5.420	0.80	0.249	1.78	55'	EL	26.923		
	EV3	Ⓢ4	1.11	47.752	1.3	0.249	1.70	55'	EL	26.920	0.659	1.11	55'	EL	5.420	0.80	0.249	1.16	55'	EL	26.923		

LOAD FACTORS:

DESIGN LOAD RATING FACTORS	LIMIT STATE	γ DC	γ DW
	STRENGTH I	1.25	1.50
	SERVICE III	1.00	1.00

NOTES:

MINIMUM RATING FACTORS ARE BASED ON THE STRENGTH I AND SERVICE III LIMIT STATES.

ALLOWABLE STRESSES FOR SERVICE III LIMIT STATE ARE AS REQUIRED FOR DESIGN.

COMMENTS:

1.
2.
3.
4.

CONTROLLING LOAD RATING

1 DESIGN LOAD RATING (HL-93)

2 DESIGN LOAD RATING (HS-20)

3 LEGAL LOAD RATING **

4 EMERGENCY VEHICLE LOAD RATING **

** SEE CHART FOR VEHICLE TYPE

GIRDER LOCATION

I - INTERIOR GIRDER

EL - EXTERIOR LEFT GIRDER

ER- EXTERIOR RIGHT GIRDER

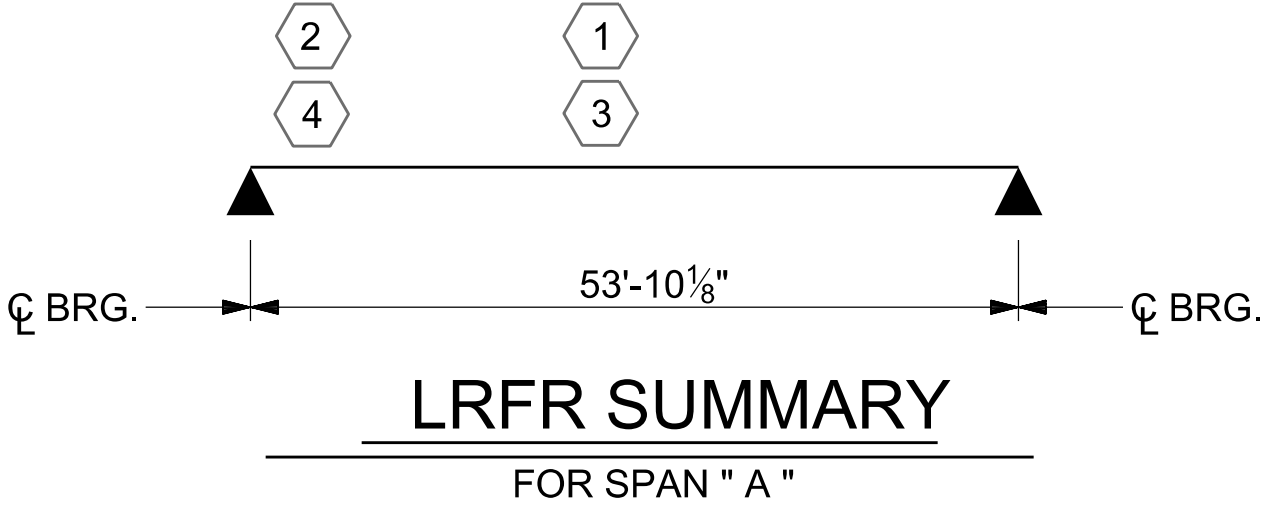

PROJECT NO. BP14.R006
POLK COUNTY
STATION: 12+92.50 -L-

DESIGN ENGINEER OF RECORD: R. C. LARSON		DATE : 6/23	
ASSEMBLED BY: J. M. DAVIS		DATE : 5/23	
CHECKED BY: R. C. LARSON		DATE : 5/23	
DRAWN BY: MAA 1/08		REV. 11/12/08RR MAA/GM	
CHECKED BY: GM/DI 2/08		REV. 10/1/11 MAA/GM	
		REV. 04/23 RNB/AM	

PLANS PREPARED BY:

N|V|5

NV5 ENGINEERS & CONSULTANTS, INC.
3300 REGENCY PARKWAY, SUITE 100
CARY, NC 27518
P: 919.851.1912 www.NV5.com
NC License # F-1333

DOCUMENT NOT CONSIDERED FINAL
UNLESS ALL SIGNATURES COMPLETED

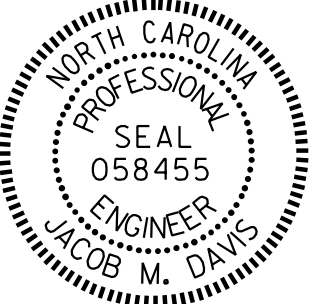

STATE OF NORTH CAROLINA
DEPARTMENT OF TRANSPORTATION
RALEIGH

STANDARD

LRFR SUMMARY FOR
55' CORED SLAB UNIT
60° SKEW & 120° SKEW
(NON-INTERSTATE TRAFFIC)

REVISIONS				SHEET NO.
NO.	BY:	DATE:	NO.	BY:
1			3	
2			4	

TOTAL SHEETS
20